

TOP SHELF, 2 OH (W 120 CM/D 42 CM), WITH CENTER PANEL

MODEL 4124.820

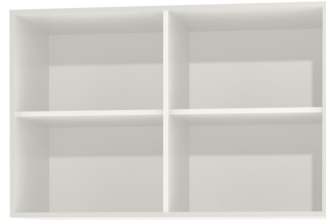

STANDARD VERSION

Body, 3-layer particle board (E1), melamine coated, highly abrasion-resistant, with 1 mm plastic edge, thickness 19 mm.

Rear panel, 3-layer chipboard (E1), melamine-coated, highly abrasion-resistant, grooved all around, thickness 8 mm.

The glued-in, 8 mm thick back panel gives the carcass its stability and strength.

Note: 1 folder height (OH) $\hat{=}$ 38.4 cm

OPTIONS

- Decoration group 2
- Shelf (additional)

STANDARD

DIN EN 14074, DIN EN 14073-2, DIN EN 14073-3, DIN EN 16121, DIN EN 16122

FEMB level:2017 (Level 3)

TECHNICAL SPECIFICATIONS

FOLDER HEIGHT	2
WIDTH	47.24 "
TOTAL HEIGHT	31.10 "
HEIGHT OF TOP CABINET	31.10 "
DEPTH	22.83 "
NO. OF ADJUSTABLE SHELVES	1
WEIGHT	112 lb

Our range of materials and colors can be found in the A2S material overview.



A2S-Furnishing Systems Ltd.
ASS-Einrichtungssysteme GmbH
info@a2s.com
WWW.A2S.COM

TOP SHELF, 2 OH (W 120 CM/D 42 CM), WITH CENTER PANEL

MODEL 4124.820



BENEFITS/SPECIALS



Board material melamine
coated with robust plastic edge



Pull-out proof shelf supports

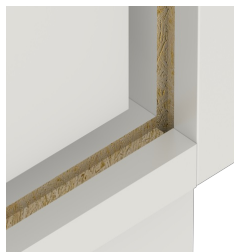

Resistance to warping due to 8
mm thick back wall



Carcass firmly dowelled and
glued ex works