

TOP SHELF, WITH CENTER PANEL FOR MULTIFUNCTIONAL BOARD SYSTEM MODEL 4741.104



STANDARD VERSION

Body, 3-layer particle board (E1), melamine coated, highly abrasion-resistant, with 1 mm plastic edge, thickness 19 mm.

Rear panel, 3-layer chipboard (E1), melamine-coated, highly abrasion-resistant, grooved all around, thickness 8 mm.

Back panel, 3-layer chipboard (E1), melamine coated, highly abrasion-resistant, grooved all around, thickness 8 mm.

With possibility to attach the aluminum guide rail for multifunctional panel system.

The color assortment for the Tidy Boxes can be selected as desired. Please specify when ordering.

OPTIONS

- Decoration group 2
- Shelf (additional)

STANDARD

FEMB level:2017 (Level 3)

TECHNICAL SPECIFICATIONS

WIDTH	41.34 "
TOTAL HEIGHT	34.25/50.39 "
DEPTH	18.90/20.47 "
NO. OF ADJUSTABLE SHELVES	3
WEIGHT	143 lb

Our range of materials and colors can be found in the A2S material overview.



A2S-Furnishing Systems Ltd.
ASS-Einrichtungssysteme GmbH
info@a2s.com
WWW.A2S.COM

TOP SHELF, WITH CENTER PANEL FOR MULTIFUNCTIONAL BOARD SYSTEM MODEL 4741.104



BENEFITS/SPECIALS



Board material melamine coated with robust plastic edge



Shelf attachment with tidy boxes behind the panels



Sliding panel with aluminum guide rails and additional storage space behind the panels



Pull-out proof shelf supports

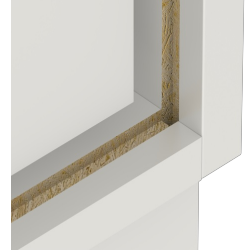

Resistance to warping due to 8 mm thick back wall



Carcass firmly dowelled and glued ex works