

# CORNER SHELF UNIT

## MODEL 4062.050



### STANDARD VERSION

Body, 3-layer particle board (E1), melamine coated, highly abrasion-resistant, with 1 mm plastic edge, thickness 19 mm.

Rear panel, 3-layer chipboard (E1), melamine-coated, highly abrasion-resistant, grooved all around, thickness 8 mm.

The glued-in, 8 mm thick back panel gives the carcass its stability and strength.

**Note:** 1 folder height (OH)  $\triangleq$  38.4 cm

Cabinet including base.

With base adjuster and base attachment panel.

### OPTIONS

- Decoration group 2

### STANDARD

DIN EN 14074, DIN EN 14073-2, DIN EN 14073-3, DIN EN 16121, DIN EN 16122

FEMB level:2017 (Level 3)

### TECHNICAL SPECIFICATIONS

FOLDER HEIGHT	5
WIDTH	27.56 "
TOTAL HEIGHT	80.31 "
DEPTH	27.56 "
ADJUSTMENT	16.54 "
DIMENSION	
NO. OF FIXED	4
SHELVES	
WEIGHT	162 lb

Our range of materials and colors can be found in the A2S material overview.



A2S-Furnishing Systems Ltd.  
ASS-Einrichtungssysteme GmbH  
info@a2s.com  
WWW.A2S.COM

# CORNER SHELF UNIT

## MODEL 4062.050



### BENEFITS/SPECIALS



Board material melamine  
coated with robust plastic edge

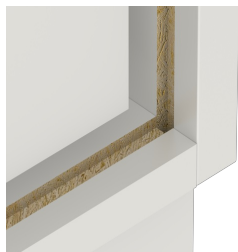

Resistance to warping due to 8  
mm thick back wall



Carcass firmly dowelled and  
glued ex works