

# HANGING SHELF, 1 FH MODEL 4939.911



## STANDARD VERSION

Body, 3-layer particle board (E1), melamine coated, highly abrasion-resistant, with 1 mm plastic edge, thickness 19 mm.

Rear panel, 3-layer chipboard (E1), melamine-coated, highly abrasion-resistant, grooved all around, thickness 8 mm.

The glued-in, 8 mm thick back panel gives the carcass its stability and strength.

**Note:** 1 folder height (OH)  $\hat{=}$  38.4 cm

## OPTIONS

- Decoration group 2
- Shelf (additional)

## STANDARD

DIN EN 14074, DIN EN 14073-2, DIN EN 14073-3, DIN EN 16121, DIN EN 16122

FEMB level:2017 (Level 3)

## TECHNICAL SPECIFICATIONS

FOLDER HEIGHT	1
WIDTH	100 cm
TOTAL HEIGHT	40 cm
DEPTH	42 cm
WEIGHT	28 kg

Our range of materials and colors can be found in the A2S material overview.



A2S-Furnishing Systems Ltd.  
ASS-Einrichtungssysteme GmbH  
info@a2s.com  
WWW.A2S.COM

# HANGING SHELF, 1 FH MODEL 4939.911



## BENEFITS/SPECIALS



Board material melamine coated with robust plastic edge

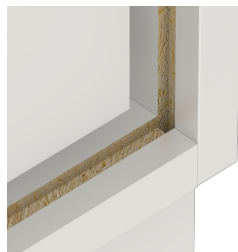

Resistance to warping due to 8 mm thick back wall



Carcass firmly doweled and glued ex works