



STANDARD VERSION

Body, 3-layer particle board (E1), melamine coated, highly abrasion-resistant, with 1 mm plastic edge, thickness 19 mm.
Rear panel, 3-layer chipboard (E1), melamine-coated, highly abrasion-resistant, grooved all around, thickness 8 mm.
The glued-in, 8 mm thick back panel gives the carcass its stability and strength.
Note: 1 folder height (OH) \pm 38.4 cm
Cabinet including base.

OPTIONS

- Decoration group 2
- Shelf (additional)
- Steel base (chrome silver 9006)
- Castors for cabinet base
- Base adjustment

STANDARD

DIN EN 14074, DIN EN 14073-2, DIN EN 14073-3, DIN EN 16121, DIN EN 16122

FEMB level:2017 (Level 3)

TECHNICAL SPECIFICATIONS

| | |
|-----------------------------|--------|
| FOLDER HEIGHT | 3 |
| WIDTH | 80 cm |
| TOTAL HEIGHT | 127 cm |
| HEIGHT OF COMBI TOP CABINET | 115 cm |
| DEPTH | 58 cm |
| NO. OF ADJUSTABLE SHELVES | 2 |
| WEIGHT | 65 kg |

3
80 cm
127 cm
115 cm
58 cm
2
65 kg

BENEFITS/SPECIALS



Board material melamine coated with robust plastic edge



Pull-out proof shelf supports



Optionally with robust steel base



Mobile on 4 castors, 2 of which are lockable

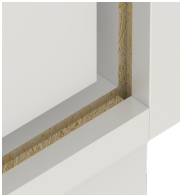

Resistance to warping due to 8 mm thick back wall



Carcass firmly doweled and glued ex works