



MUNICIPAL COMPREHENSIVE SCHOOL LANGENFELD





1



5



6

1/2 This self-learning area, around the circular unit of cupboards and upholstered seats, offers various study areas - for single students or groups. Diverse lounge-furniture creates protected corners for a relaxed exchange in between studies.

3/4 The library, in the second, slightly more open self-learning area, offers table groups in various sizes as well as computer work places and a lounge area.

5 The calm classrooms, in colour-glazed decorative concrete, are furnished with modest grey furniture.

6 The combination of two classrooms creates the so-called school-academy. When needed, two mobile partitions convert the large room into two separate classrooms.

7/8 The cafeteria is loosely arranged into areas for large and small groups. Above and beyond the normal mess hall setup, the long wall-table as well as a comfortable lounge area create an inviting café-like effect.

9 The spacious, open foyer with a terrazzo floor can also serve as an auditorium. This area, which during the day is filled with streams of children, can be converted into an event hall that seats up to 250 people. Stackable chairs that can be connected to form tidy rows make for quick and easy setup alterations.



7



8

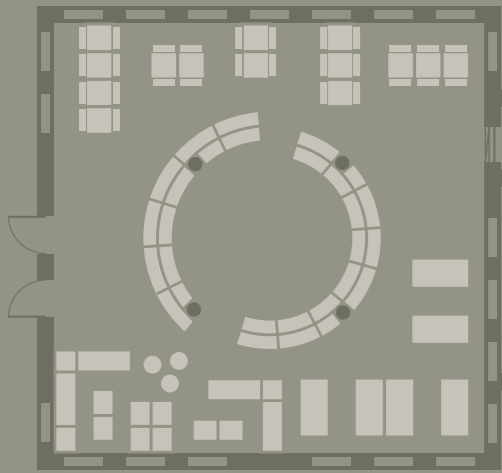

2



3



4



9

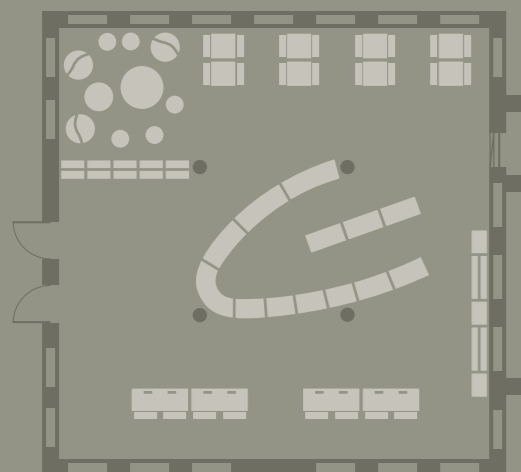



# BUILDING

---

Municipal Comprehensive School Langenfeld, 2016

---

## Project

Construction of a 3-storey school building with room for up to 500 students as well as administration- and service-areas.

---

## Concept

The modern construction of the "Town-Centre Learning Campus" brings classical and new forms of learning under one roof. Here, depending on circumstances and furnishing, 17 school classes learn either in classrooms, speciality areas or in one of the two self-study centres. The open foyer and the cafeteria offer lively meeting places for everyone during the entire day.

---

## Architects

architecture/overall planning: Stadt Langenfeld

specialist planning for furnishing:

gpe-projekt Gesellschaft für Planung & Entwicklung Meschede

---

# FEATURES

---

Interior Design

---

## Concept

The furnishing matches the unpretentious, friendly concept of the building. A lively mix of materials, colours and shapes creates a high-quality and functional educational environment with a homey atmosphere. Specifically the cafeteria, the heart of the school, with its modern cosiness, provides an inviting place to linger for a while.

---

## Options

The airy foyer, when filled with chairs, serves as an auditorium for up to 250 people. Single tables in each classroom allow for flexible learning: whether individual work, lecture-style teaching or in groups. The large self-learning centres can be used by individuals or by entire groups - digital and conventional.

---

## Sustainability

Quality that's made in Germany. Responsible management of resources is essential for products that will shape generations to come. A2S have already netted a host of awards and certificates for their short manufacturing chains, refusal to use solvents and tropical woods and standards that lie well within legal maximums.

---



DER BILDUNGSEINRICHTER.